

SuperLite® II-XLM 120

120 Minute Fire Resistant
Multilaminated Glazing

PRODUCT ADVANTAGES



- ▶ Fire resistant multilaminated glazing offering maximum fire and safety with hose stream for 120 minute wall applications.
- ▶ Meets ASTM E-119 for full radiant heat protection and CPSC Cat. II (400 ft. lbs.) impact safety requirements.
- ▶ Can be used in interior and exterior applications, including clear butt-glazed walls for maximum vision and transparency.
- ▶ Optically clear glazing without wires or tints.
- ▶ Can be easily incorporated in GPX® Architectural Series Framing, GPX® SNAPCAP or GPX® Builders Series Temperature Rise Framing for a complete fire resistant assembly.
- ▶ Standard 5 year limited warranty.
- ▶ Fabricated in the U.S.A. for fast lead times.

Large Sizes for Sidelites, Windows, Transoms and Walls

Fire Rating	Max. CV Area	Max. CV Width	Max. CV Height	Stops
120 minute wall (with framing and butt-glazed)	4,256 in. ² (2.75 m ²)	38 in. (0.97 m)	112 in. (2.84 m)	1 in. (25.4 mm)

FIRE RESISTIVE

Contains smoke, flames and blocks the passage of radiant heat.

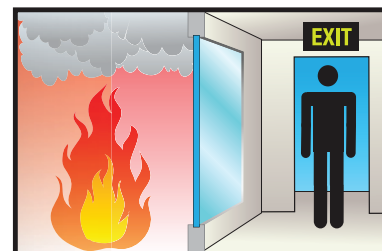

SPECIFICATIONS

Thickness: 2-1/8 in. (53 mm) standard

Weight: 25 lbs./sq. ft. (122 kg/m²)
in 2-1/8 in. (53 mm) standard

Sound Reduction: Rw=46 dB

Fire Rating: 120 minutes with hose stream
Meets ASTM E119, NFPA 251 and UL 263

Impact Safety Rating:

CPSC 16 CFR 1201 Cat. I and II,
ANSI Z97.1

Light Transmission: 71%

R-value: 1.18

U-value: 0.845

3-Part Specifications:

Available at

www.safti.com/specifications

UL AND INTERTEK TESTED AND CERTIFIED



SuperLite® II-XLM is listed and labeled by Intertek and Underwriters Laboratories, nationally recognized testing laboratories approved by OSHA.

APPROVALS

UL 9, UL 10B, UL 10C, UL 263, NFPA 80, NFPA 251, NFPA 252, NFPA 257, ASTM E119, ASTM E152, ASTM E163, ASTM E2074, ASTM E2010-01, CPSC 16 CFR 1201 Cat. II, ANSI Z97.1, ULC CAN4-S101, ULC CAN4-S104, ULC CAN4-S106.

SuperLite® II-XLM 120

120 Minute Fire Resistive
Multilaminare Glazing



Project: Waste Management Headquarters in Houston, TX
Architect: Perkins + Will
Contract Glazier: Lakeview Glass and Mirror
Products Used: SuperLite® II-XL 90 in
GPX® Builders Series Temperature Rise Doors and
SuperLite® II-XLM 120 in GPX® Architectural Series Wall

TYPICAL DETAILS *More details available at www.safti.com/details*

SuperLite® II-XLM 120 in GPX Architectural Series Framing

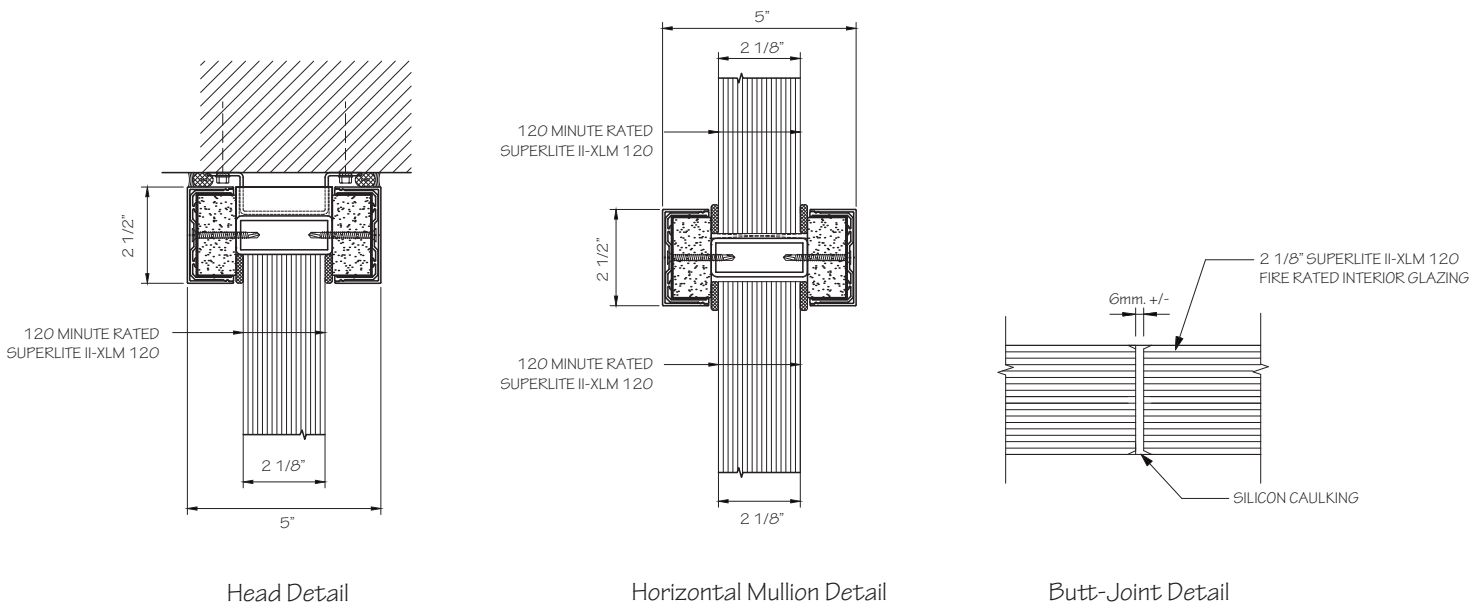

Details not to scale.

The information provided herein is for general reference only and is subject to change without notice. Please visit www.safti.com for the most up to date information.

© SAFTI FIRST® October 2021